



Brett Schulz
architect, pc

2222 NE Oregon St. # 203
Portland, Oregon 97232
www.brettschulz.com
T: 503.222.9099

**NEW NEW
CRUSHER
COURT**
2500 NE SANDY BLVD.
PORTLAND, OR 97232

PERMIT:
APPEAL:

ISSUE:

ISSUE DATE: 5/25/16

DRAWN: SG

APPROVED: BJS

REVISIONS:

- 1 3/4/16
- 2 4/18/16
- 3 4/28/16
- 4 5/09/16
- 5 5/25/16
- 6 10/14/16

SCALE: AS NOTED

**PICKATHON T.I.
PLAN**

A2.0

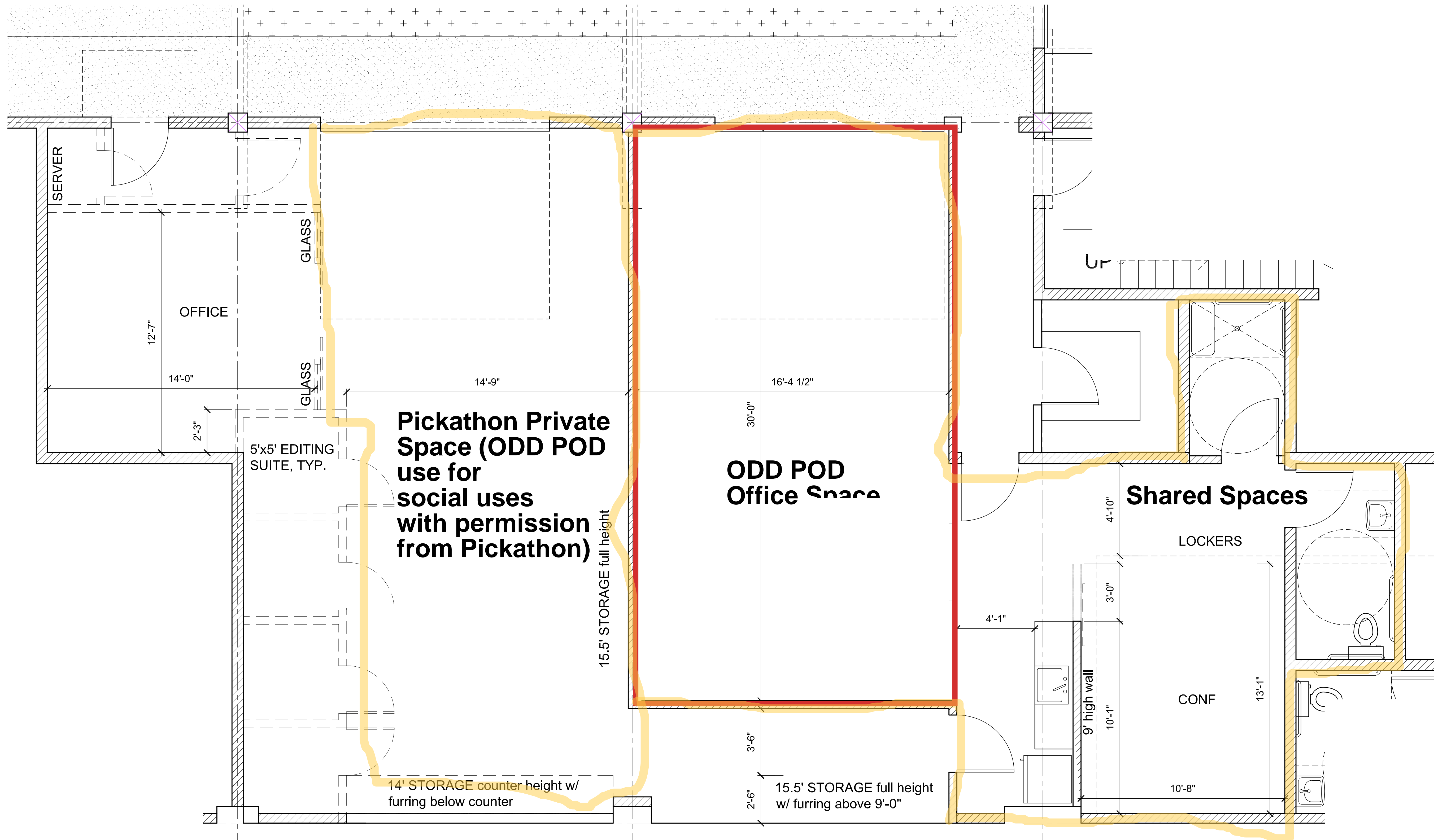

1 PICKATHON OFFICE PLAN

3/8" = 1'-0" @ 22 X 34, = 3/16" @ 11 X 17

